

MOUNTING INSTRUCTIONS

YOU NEED:

- GLOVES
- SCRAPER
- MOUNTING SPRAY
- CLOTH

(Tweezers can facilitate button mounting)



NOTE! ALWAYS CLEAN THE SURFACE WHERE THE FILM SHOULD SIT BEFORE APPLICATION!

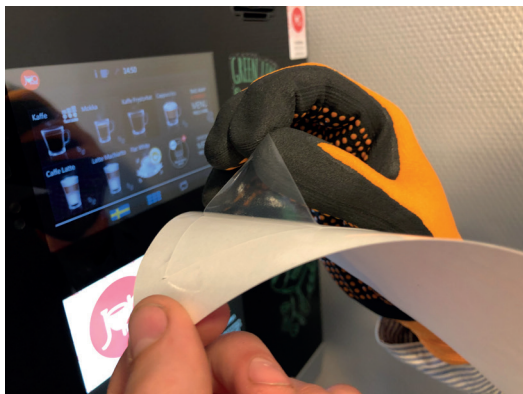

1.

Remove 1/3 of the paper on the back and fold down the paper. Gloves are recommended when grease stains from fingers get stuck in glued to the film.

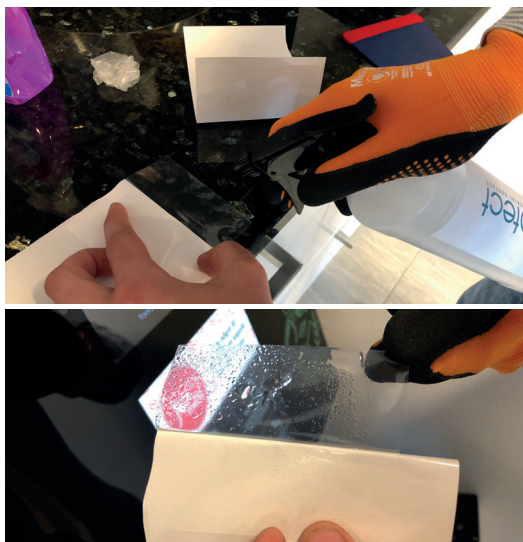

2.

Apply mounting fluid to the back of the film. Keep 2/3 of the paper left.



3.

Apply the film from one edge of the screen and adjust it before pressing the film with the scraper.



4.

Now remove the paper and apply mounting fluid on the entire back of the film.



5.

Hold the film stretched with one hand and scrape out the liquid underneath with the other hand. It is important that you see the liquid coming in front of the scraper, otherwise apply more liquid.



6.

When all the liquid has been scraped out, wipe off excess liquid with a soft cloth.

Placement of lifespan label



Mounting label showing the lifespan of the screen protector is attached on the inside of the door on suitable place.

A close-up of a lifespan label. The label is light blue and contains the following text:
JDE | PROFESSIONAL 4Protect
TOUCH SCREEN PROTECTION APPLIED:
DATE:
NEW PROTECTOR REQUIRED: (+3 YEARS)
DATE:
BATCH ID: 4P-C007701C
TCT PRODUKTION

Fill in the dates